

Innogreen
英诺格林·净水专家

Company Profile

Beijing Innogreen Technology Co., Ltd



Company Address

Floor 3 Plaza A Zhonglin Real Estate Building, No.28 South 3rd Ring West Road, Fengtai District, Beijing, China



Telephone Number

+86 400-020-5558



Company Website

www.innogreen.com



1

About Us

2

Business Fields & Products

3

Cooperative Partners

CONTENTS

Innogreen 英诺格林 · 净水专家



01

About Us

Company Profile

Innogreen
英诺格林 · 净水专家



Innogreen
英诺格林 · 净水专家



Beijing Innogreen Technology Co., Ltd., founded in Beijing 2004, is one of the best water treatment enterprises integrating R&D and manufacturing of membrane & products, EPC works, and professional operation & maintenance service.

21

Founded in 2004

5

International Strategic
Partners

80+

Test Equipment

30+

Certificates

66

Industries

140,000 m²

Production Workshop

60+

Patents

700+

Employees

3000+

Clients Home & Abroad

3

R&D Centers



2004 •

2004

Company Founded

- Established in Zhongguancun, Beijing
- Completed construction of the first production workshop in Beijing

2008

Industry Leader in Water Purifiers

- Became the largest manufacturer of purified water equipment in northern China
- Designated supplier of purified water equipment for the Beijing Olympic logistical services
- One of the first companies to donate water purification equipment for the Wenchuan Earthquake relief
- Recognized as one of China's Top Ten Water Purifier Brands

2012

Expansion into Wastewater Sector

- Established divisions for residential terminal purification, industrial ultrapure water, softened water, laboratory ultrapure water, and EDI systems
- Founded the Wastewater Division
- Received investment from Legend Capital and Legend Star
- Constructed China's second-largest nanofiltration system in Xilinhot

2015

Leap in Capital Development

- Signed strategic agreement with listed company Kerong Environment
- Launched the first BOT project
- Implemented the first PPP operation project
- Constructed the Koubei Water Project

2019

Top Three in Membrane-Based Water Treatment

- Served over 1,000 clients
- Became No.1 in water treatment for the waste incineration and biomass power generation industries
- Annual usage of over 30,000 RO membrane elements
- Strategic partnerships with Toray and DuPont
- Built the largest dual-membrane system in northern China

2020

Solidifying Sustainable Development in Manufacturing

- Established the largest one-stop environmental protection base in northern China
- Founded the New Business Development Center
- Expanded into post-service segments of water treatment engineering
- Entered the rural environmental management market

2021

Industry Integration and Shared Growth

- Integrated the four major business segments of the group
- Chairman recognized as a Key Influencer in Rural Water Environment in 2021
- Participated projects awarded the National Quality Engineering Award
- Visited by China's Vice Premier and Governor of Liaoning Province

2024

The Overseas Business Having Taken Initial Shape

- The Group launched a new 10-year strategic layout.
- Signed a photovoltaic green hydrogen production x0002 project with Longi for Australian Gas Infrastructure Group (AGIG).
- Successively signed multiple overseas projects in Russia, the United Arab Emirates, Uzbekistan, Kazakhstan, Indonesia, etc.
- Successfully won the bid for the Huajin Arameo 3250T/H condensate polishing system (the most well known domestic project with the largest water treatment capacity in 2024).

2025

- ISO9001 Quality Management System Certificate(Design, production)
- ISO9001 Certificate of Quality Management System Certification (Installation)
- ISO14001 Environmental Management System Certificate
- ISO45001 Occupational Health and Safety Management System Certification
- 17 Software Copyrights ● 45 Patents for Inventions



**Construction Enterprise
Qualification Certificate**

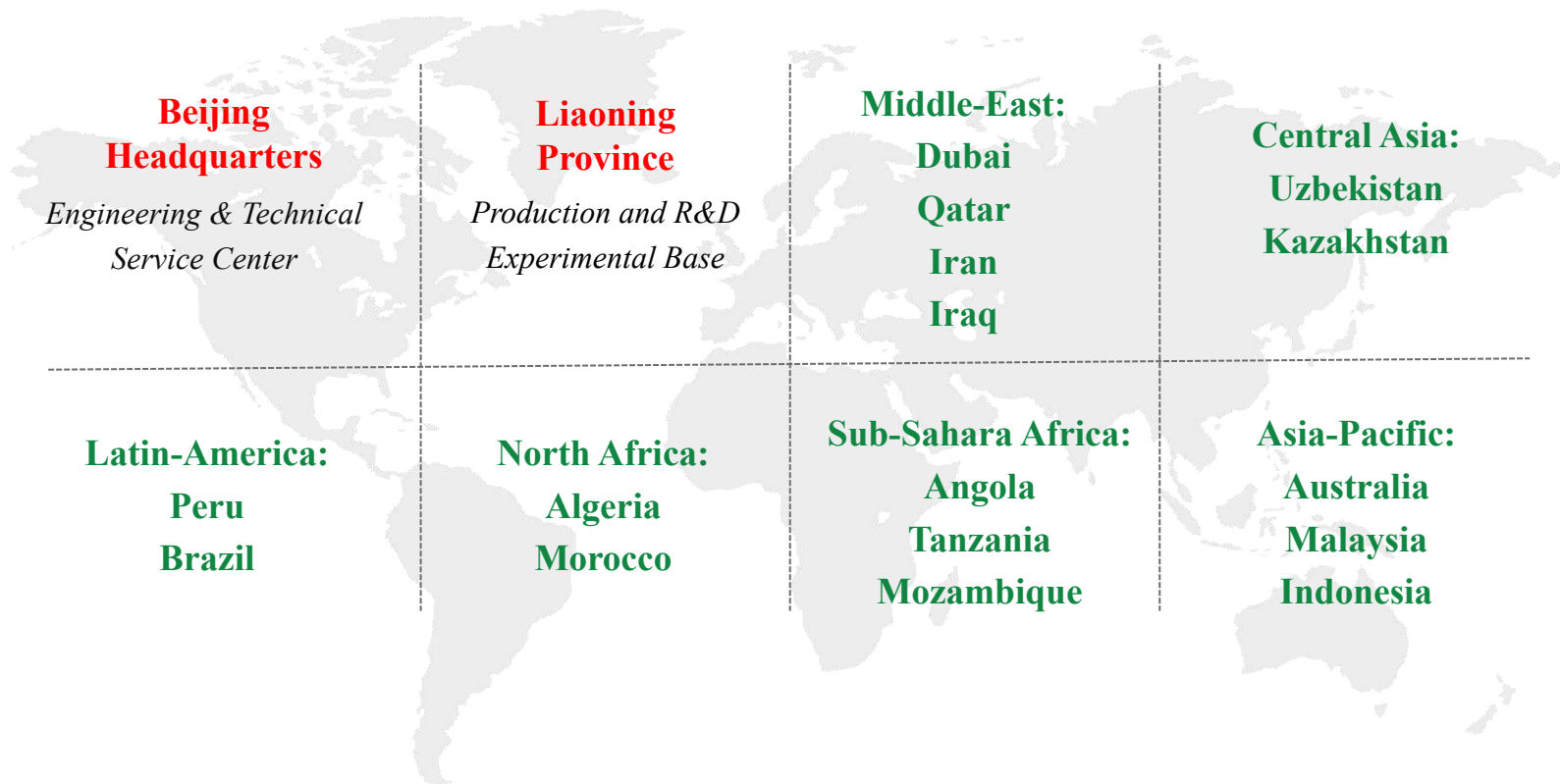



1. Integrated domestic sewage treatment equipment



2. Filtration/ion exchange equipment



3. Hollow fiber UF membrane



4. Drinking water integrated purification equipment



5. Sodium hypochlorite generator equipment



6. DTRO waste leachate treatment equipment



7. Waterworks construction equipment



8. Water treatment chemicals



9. Seawater desalination



10. UED high toxic, high-salt & high-concentration wastewater treatment unit



11. Glass fiber reinforced plastic (GFRP)

Industry-leading Water Quality Analysis Laboratory

Innogreen
英诺格林·净水专家



General Physicochemical
Parameter Test



Routine Ion Analysis



Metal Parameter Test



Microbiological
Parameter Test

FREE sampling test services

More than **80** sets of advanced testing equipment

More than **100** tests of various water quality and environmental indicators

02

Business Fields & Products



Municipal Waterworks

Purify water sources to produce drinking water that meets safety standards.

Technological Process

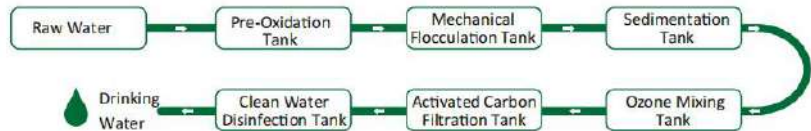

Water Purification Process for Water Sources Contaminated with Trace Organic Compounds

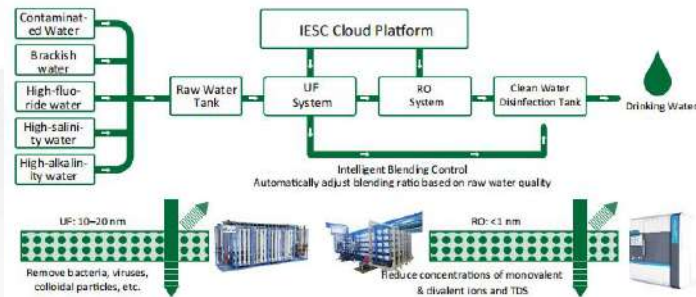

Dual-Membrane Process for Ion-Exceeding Raw Water in Drinking Waterworks

Typical Cases



Self-invested Flagship Project:
the Taiji Water Purification
Plant in Beipiao, Liaoning

Treatment capacity: 80,000 t/d



Woniushan Waterwork of Yantai
Economic & Technological
Development Zone Tap Water
Co., Ltd.

Treatment capacity: 67,000 m³/d
Main process: UF + RO dual-
membrane



Process Upgrade and Renovation
Project of Gan'nan Town Water
Purification Plant in Gannan
County

Treatment capacity: 30,000 t/d
Main process: UF + RO



Shanba Town Tap
Waterwork in Inner
Mongolia

Treatment capacity: 40,000 t/d
Main process: UF + RO



Industrial Application: Power, Chemical, Metallurgy, etc.

Treat raw water to meet industrial water standards, including water for power generation, chemical production, metallurgy, and other industries.

Treatment Processes	Application Scenarios	Product Water Quality Standards
Chemical dosing + sedimentation + filtration	Industrial water, circulating water, and cooling water in factory areas	Design Code for Industrial Circulating Cooling Water Treatment (GB 50050)
Mechanical filtration + RO	Process water and cleaning water for chemical production	Desalination rate $\geq 98\%$ Iron content ≤ 0.05 mg/L
Mechanical filtration + RO + softening	Medium and low pressure boiler feedwater	Industrial Boiler Water Quality Standard (GB/T 1576)
Mechanical filtration + cation exchanger + anion exchanger + mixed bed	Thermal power plant boiler water, high pressure boiler water	Water and Steam Quality for Thermal Power Units and Steam Power Equipment (GB/T 12145)
UF + two-stage RO + EDI	General boiler water	Water and Steam Quality for Thermal Power Units and Steam Power Equipment (GB/T 12145)

Typical Cases



Rongcheng Natural Gas
Cogeneration Project

Boiler 3 × 200 m³/h Feed Water
Treatment System



Boiler Feedwater Treatment
System Project of Thermal
Power Plant for Yihai Jiali (Fuyu)
Energy Co., Ltd.

Treatment capacity: 2×200 m³/h
Process: UF + Primary RO +
Secondary RO + EDI



Demineralized Water Treatment
System for 50,000-ton/year
Dodecanedioic Acid Project of
Ningxia Hengli Biomaterials New
Materials Co., Ltd.

Capacity: 3×90 t/h
Process: UF + RO + EDI (Full-
membrane process)



Huaneng Group Northern United
Power Haibowan Power Plant
Project

Boiler 2×220 MW + 2×330 MW
Feed Water Treatment System



Seawater Desalination

Remove salt and impurities from seawater to produce fresh water suitable for drinking or other uses.

Technological Process

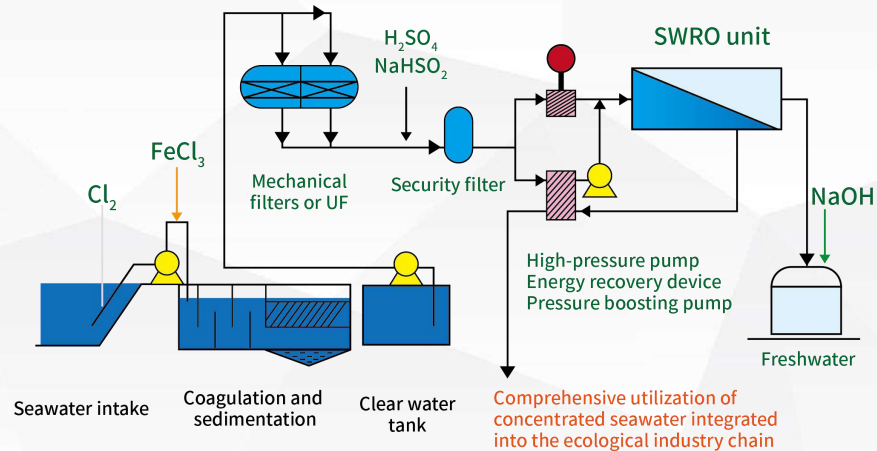

Typical Cases



Peru Seawater
Desalination Project

Capacity: 1,000 t/d
Process: Water Intake System +
Oil Removal + Filtration +
Seawater RO Membrane System



Mozambique Seawater
Desalination Project

Capacity: 1,000 t/d
Process: UF + RO



Aral Brackish Water Desalination
Project of the 11th Regiment, First
Division of Xinjiang Production and
Construction Corps

Capacity: 10,000 t/d
Process: High-density
sedimentation tank + V-type
filter + Mechanical filtration +
High-pressure RO



Angola Seawater
Desalination Project

Capacity: 500 m³/d



Municipal Sewage Treatment Plant

Purify urban wastewater to meet discharge or reuse standards.

Technological Process

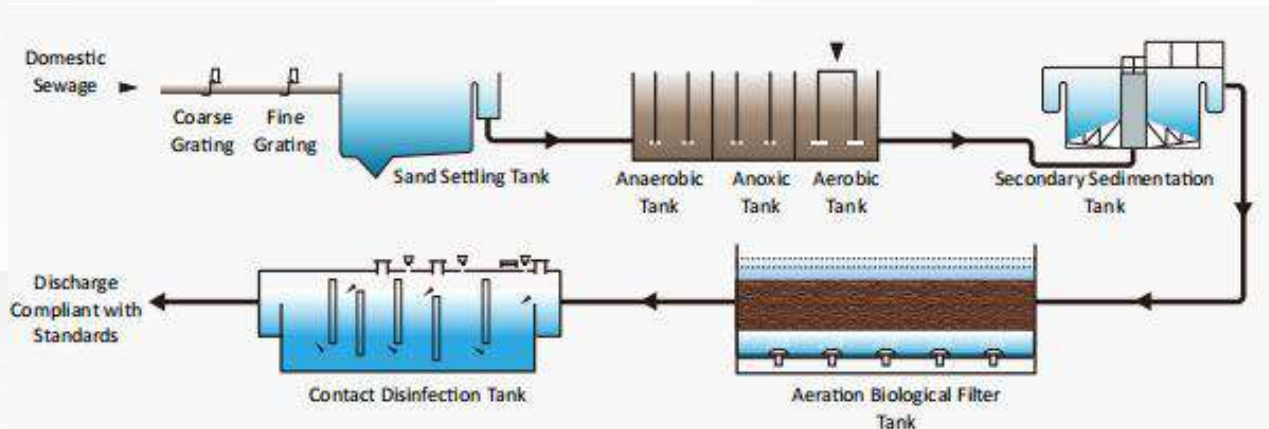

Typical Cases



Domestic Sewage Treatment
Project for the Supporting Living
Service Center of Beijing
Tongzhou New Government
Complex

Capacity: 300m³/d
Process: A²O + Multi-stage
Biological Multiplication +
Advanced Treatment



Town-level Sewage Treatment
Plant Construction Project in
Shenzhou, Hengshui

Capacity: 300-700-1000-1200m³/d
Process: A²O + MBR



Newly Built Sewage
Treatment Plant Project in
Linyi, Shandong

Capacity: 40,000 m³/d
Process: Pre-treatment + Modified
A²/O + Secondary Sedimentation
Tank + Magnetic Coagulation
Sedimentation + Denitrifying
Filter + Ozone Contact Tank +
Contact Disinfection Tank



Dongguan Sewage Treatment
Plant Project in Beipiao City

Capacity: 1,200m³/d
Process: A²O + Multi-stage Bio-
doubling

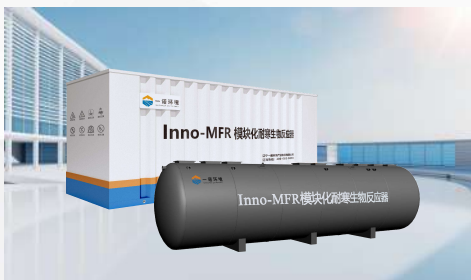

Small and Medium-sized Wastewater Treatment Plant / Integrated Equipment

Integrated wastewater treatment equipment for small and medium-sized plants/process small-scale or decentralized wastewater to meet discharge or reuse standards.

Technological Process

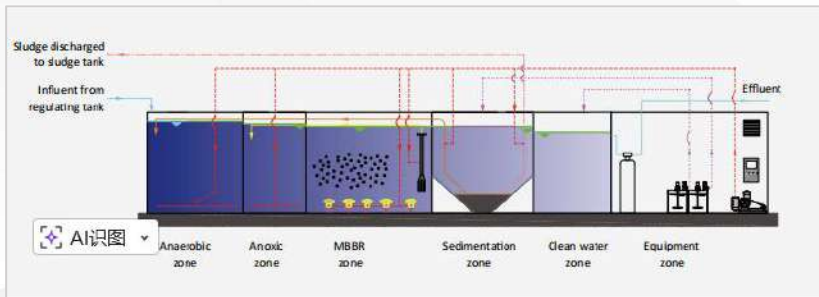

Above-Ground Type

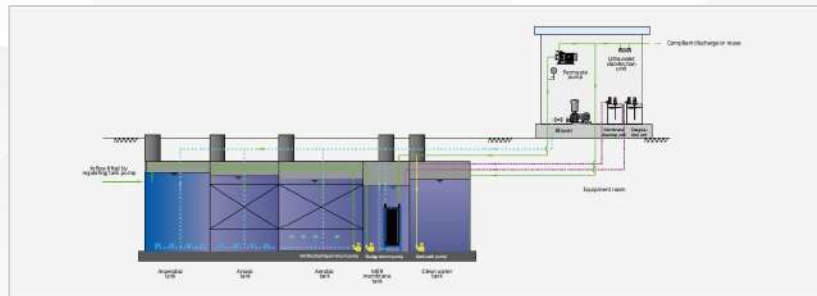

Buried Type

Typical Cases



Sewage Treatment in Yabuli,
Heilongjiang

Capacity: 1,400 m³/d
Process: A²O + Sedimentation
Tank + Phosphorus Removal
Filter



Sewage Treatment for Xiong'an
Project

Capacity: 1,400 m³/d
Process: Regulating Tank + 100
m³/d Integrated Sewage
Treatment Equipment + Lift
Pump Station (52 Sets in Total)



1000 t/d Domestic Sewage
Treatment Project in Sanjiazi,
Jianping

Capacity: 1,000 m³/d
Process: A²O + Sedimentation
Tank + Phosphorus Removal
Filter



Domestic Sewage Treatment
Project for Residential Service
Area of Beijing Administrative
Sub-center

Capacity: 300 m³/d
Process: A²O + Multi-stage Bio-
doubling + Advanced Treatment

Enterprise Water Treatment Operation & Maintenance Service Butler

3 types of water treatment products

Membranes



Water Treatment Agent



Specific Consumables



3 types of operation & maintenance expert

Water treatment butler



Water treatment doctor



Innovative 6S 3D service

Save water	Save power	Save agent
Save heat	Save labor	Save consumption

Water Treatment “Butler + Doctor” Service

Butler Service



Full-trust operation



Turnkey chemical supply operation



Professional operator dispatch operation

Doctor Service

Early warning and precise diagnosis of online & on site issues



600+ items of online and on-site inspections across 12 major categories



System retrofit & capacity expansion



Emergency repair



Major overhaul of system



Equipment maintenance

Replace or guide users in undertaking all daily operation tasks of water treatment equipment



Online/offline
cleaning
services



Membrane
element
installation &
commissioning



Filter media
replacement



Resin
regeneration/
replacement



Instrument
calibration &
testing



Water quality
laboratory
testing



Online/offline
cleaning
services



UF membrane
integrity testing



EDI
online/offline
cleaning



EDI module
disassembly
& diagnosis



EDI module
reset



Professional
operator
training



Cooling tower
coil cleaning



MBR
online/offline
cleaning



Heat
exchanger
cleaning



Membrane-based
water treatment
equipment leasing

>> Aceclean UF membrane <<



Main Types

Module		D	L	L1	L2	L3	w1	w2
ACE-160L-03	SI (mm)	Φ 160	1860	1500	1630	1820	180	345
ACE-225L-03	SI (mm)	Φ 225	2360	2000	2130	2320	180	345

Comparison of Parameters

Brand	Type	Filtration way	effective membrane area m ²	Membrane module capacity (L)	Permeate flux (25° C)	Flow rate range	Permeate turbidity
Aceclean	ACE-225L-03	external pressure	77	39	40 - 110 l/m ² /hr	3.2 - 8.5 m ³ /hr	≤ 0.1 NTU
Dupont	SFP-2880	external pressure	77	39	40 - 90 l/m ² /hr	3.1-6.9 m ³ /hr	≤ 0.1 NTU
Toray	HFUG-2020AN	external pressure	72	43	40 - 187.5 l/m ² /hr	3.2-13.5m ³ /hr	≤ 0.1 NTU
Toray	HFUG-2020AN	external pressure	90	53	40 - 166 l/m ² /hr	3.2-15m ³ /hr	≤ 0.1 NTU
Asahi Kasei	UNS-620A	external pressure	50	23	40 - 160 l/m ² /hr	3.2 - 8.5 m ³ /hr	≤ 0.1 NTU

>> Aceclean RO/NF Membrane <<



Main Types

Function	Type	Stable salt rejection rate	average permeate flow rate GPD (m ³ /d)	Effective membrane area Ft ² (m ²)
high-rejection brackish water membrane element	ALR-100	0.997	10500 (39.7)	400 (37.2)
anti-fouling membrane element	AGR-100	0.997	10500 (39.7)	400 (37.2)
seawater desalination membrane element	ASW-100	0.998	7000 (26.5)	400 (37.2)
NF membrane element	ANF-8040-34	≥97.0%	10000 (37.9)	400 (37.2)

Comparison of Parameters

Brand	Type	Permeate flow rate(gpd)	Stable salt rejection rate(%)	Effective membrane area (ft ²)	Flow channel width(mil)
Aceclean	ALR-100 brackish water	10500	99.7	400	28
Dupont	BW30PRO-400IG	10500	99.5	400	28
Toray	TM720D-400	11000	99.8	400	34
Hydranautics	CPA3-LD	11000	99.7	400	31
Veolia	AG8040F-400	11000	99.5	400	28
Aceclean	AGR-100 anti-fouling	10500	99.7	400	34
Dupont	BW30FR-400/34	11000	99.5	400	34
Toray	TML20D-400	10500	99.8	400	34
Hydranautics	PROC10	10500	99.75	400	34
Veolia	AG8040F-400 FR,34	11000	99.5	400	34



- RO-specific scale inhibitor Aceclean-220
- RO-specific cleaning agent (acid) Aceclean-430
- RO-specific cleaning agent (alkali) Aceclean-440
- RO-specific non-oxidizing biocide Aceclean-781
- RO-specific reducing agent Aceclean-400
- Circulating water-specific corrosion and scale inhibitor Aceclean-415
- Circulating water-specific slime dispersant Aceclean-560



Aceclean water treatment specific filter element



Activated carbon



Quartz sand



Anthracite



Manganese sand



Softening resin



**Cation resin
Anion resin
Mixed-bed resin**



Polishing resin



Specialty resin

Major Equipment Products



Disc Filter



Self-Cleaning
Filter



Media Filter



UF System



RO System



EDI Unit



Seawater
Desalination Unit



DTRO ZLD
System



Emergency Water
Purification Vehicle



Ion Exchanger



Filtration Tank



Containerized
Equipment



Dosing
Equipment



Electrical Automatic
Control Equipment



NaClO Disinfection
Equipment

03

Cooperative Partners

Strategic Partners

Service creates value, cooperation wins trust



Learning / Responsibility / Innovation



COMPLETE: Full-process of water treatment

SOLE: Expert of water treatment



THANKS